

CB.0350.0800.0800.SOLAR LIGHTING DESIGNS

CB.0350.0800.0800.SOLAR LIGHTING DESIGNS

H 350 X W 800 X L 800
WEIGHT 450 - 490KG

2 of 2.5 tonne lifting point (cone anchor)

20MPa concrete
85% recycled materials

Notes:

1. 4 OF M20 HOLD DOWN BOLT AT 233MM PCD
2. 2 OF 145X45MM (INTERNAL) FORKLIFT POCKET (GALVANISED RHS SECTION)
3. 2 OF SL82 REINFORCING MESH

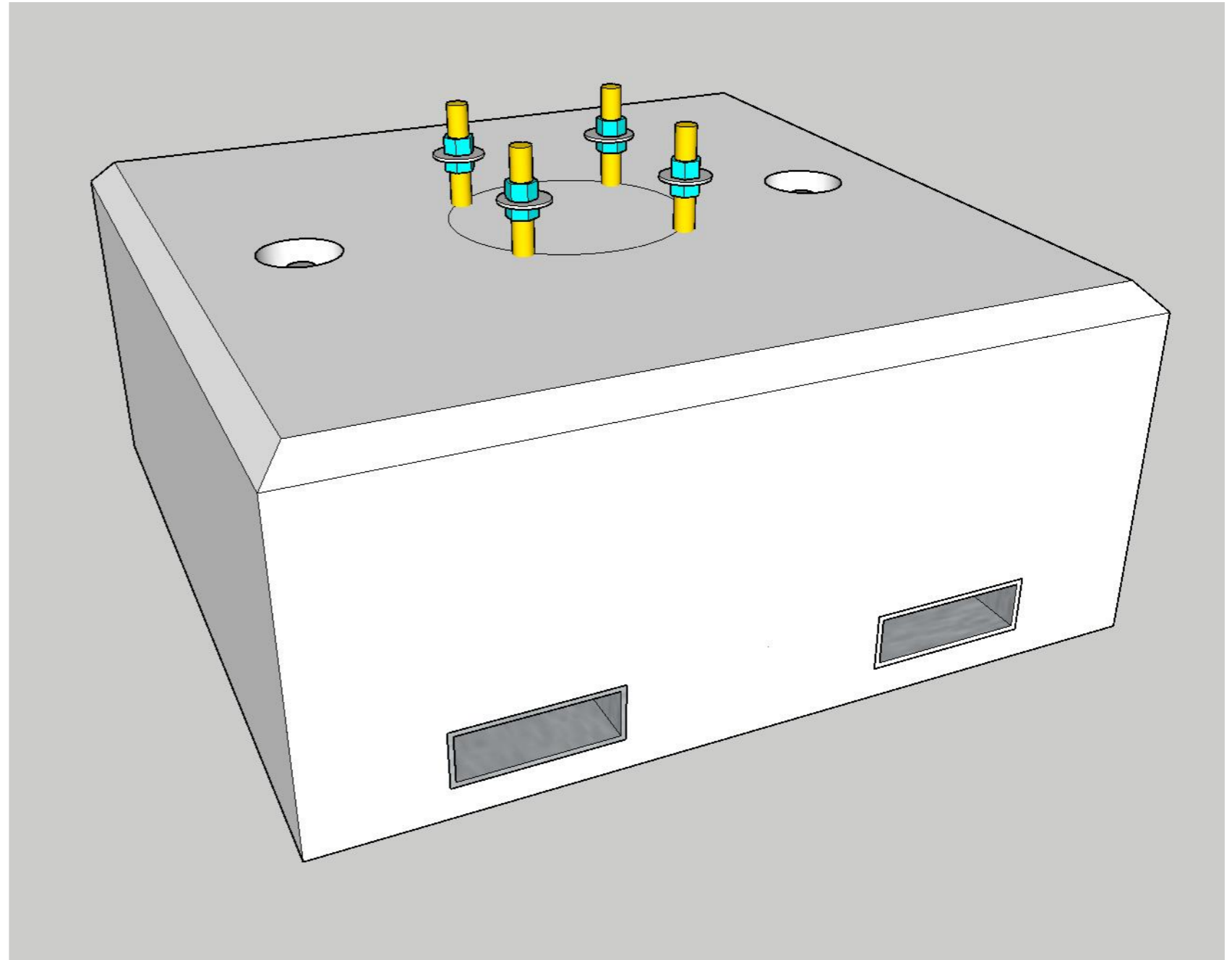

sustainable precast concrete

CB.0350.0800.0800.SOLAR LIGHTING DESIGNS



Disclaimer: This drawing has been prepared by Precast Concrete Aust Pty Ltd. This drawing is intended for conceptual purposes only. Anyone making use of this drawing does so at their own risk and assumes all liability for such use. Final design for construction purposes must be completed by a Registered Professional Engineer who is familiar with the product and who has taken into account site specific conditions.

June 26, 2023

FRONT VIEW

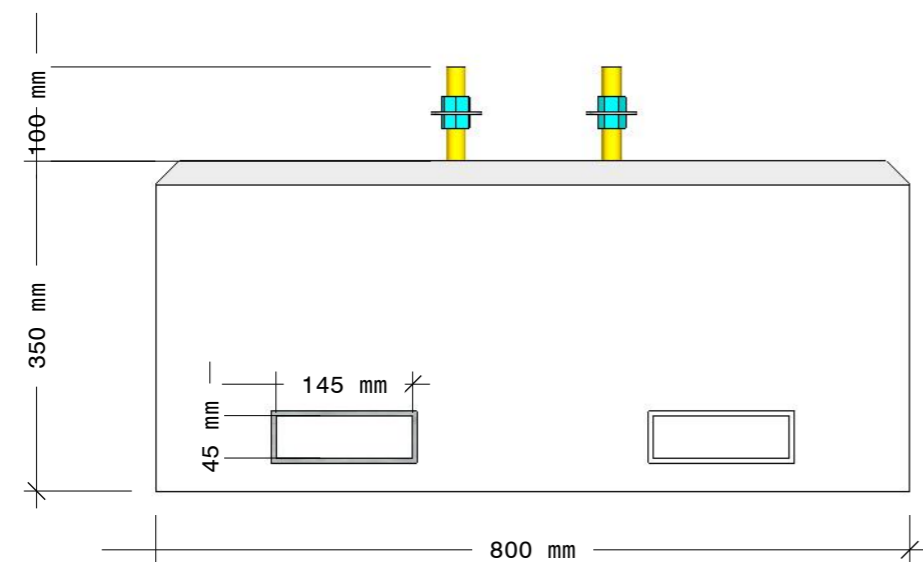

RIGHT SIDE VIEW

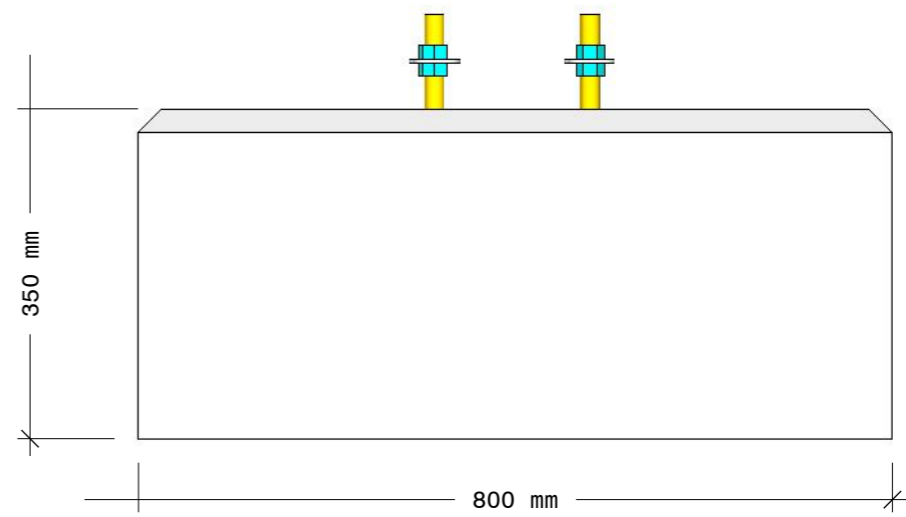

TOP VIEW

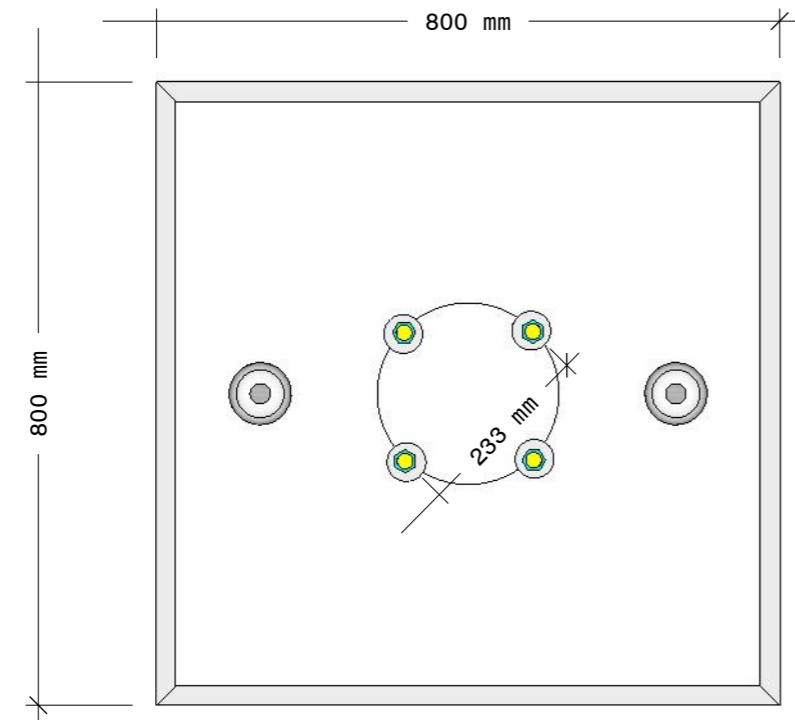

ISOMETRIC VIEW

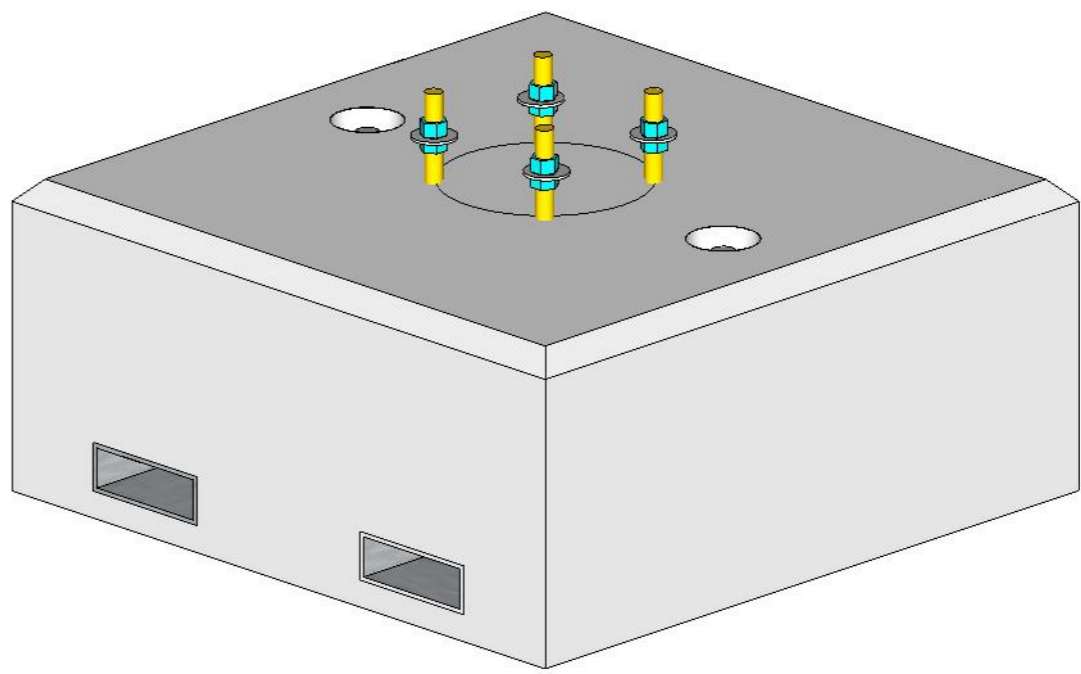

FRONT, RIGHT, TOP AND ISO



CB.0350.0800.0800.SOLAR LIGHTING
DESIGNS

A 01

PRODUCTION INFORMATION

PART NUMBER	CB.0350.0800.0800
QTY REQUIRED	3 OF
FINISH	TROWEL
CONCRETE MIX	20 MPA

QC CHECK - PREPOUR

ITEM	DETAIL	INITIAL
DIMENSIONS	CHECKED	
REINFORCING	CHECKED	
LIFTERS	SIZE & POSITION	
MOULD	BRACED & SEALED	
CAST-INS	SIZE & POSITION	

QC CHECK - POST POUR

ITEM	DETAIL	INITIAL
LIFTERS	POSITION	
CAST-INS	SIZE & POSITION	
DIMENSIONS	CHECKED	
READY FOR DISPATCH	DATE:	

4 OF M20 HOLD DOWN BOLT AT 233MM PCD

2 OF 2.5T CONE ANCHOR LIFTER

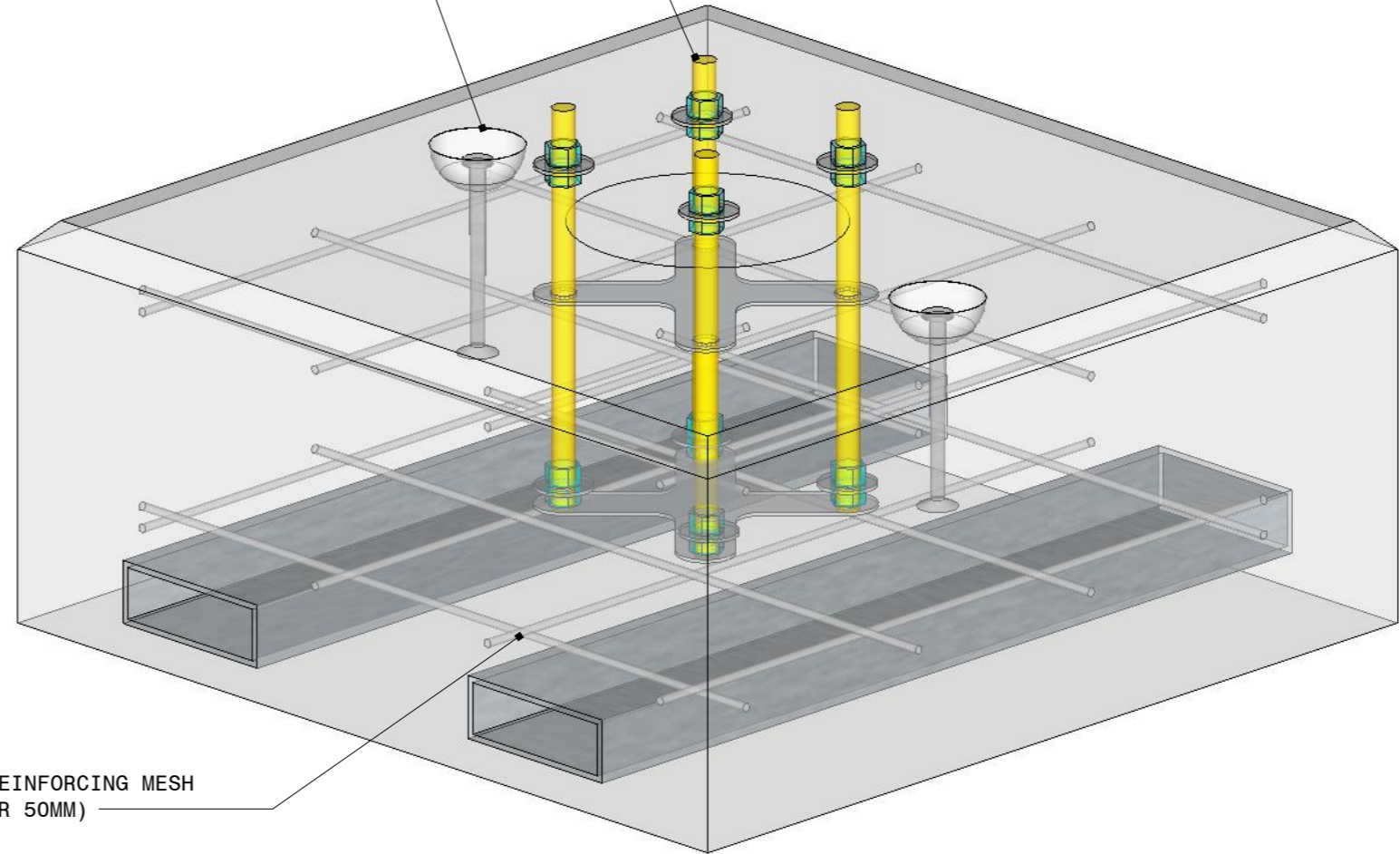

2 OF FORKLIFT POCKET 145 X 45MM INTERNAL DIMENSIONS -

2 SHEETS OF SL82 REINFORCING MESH (MIN COVER 50MM)